

URE

Fuses for Semiconductor Protection - European Standard



Class:	aR
Voltage ratings:	240V _{AC} to 700V _{AC}
Current ratings:	5 A to 900 A
Standards:	IEC 60269-4 BS 88-4

Features and Benefits

- ▶ Extremely High interrupting ratings 100kA
- ▶ Protection of Power Semiconductor according to IEC 60269 -4
- ▶ Complies with BS 88 Standard
- ▶ Class; aR, 5A - 900A according to IEC 60269-4
- ▶ Fuse accessories available - Microswitches for fuses with striker.

Fuses for Applications

Article	Description	Selection Guide	Technical Data
240V_{AC}			
5007606	8.4mmx27mm-38mm mounting	Blown fuse indication - add on	292
5005306	17.5mmx26mm-40mm mounting		294
5005406	35mmx31mm-59mm mounting		296
5007106	2X35mmx31mm-59mm mounting		298
690V_{AC}			
5007706	8.4mmx54mm-64mm mounting	Blown fuse indication - add on	300
5007306	17.5mmx48mm-63mm mounting		302
5007406	35mmx52mm-80mm mounting		304
5007506	2X35mmx52mm-80mm mounting		306
000 DIN 85			
2056120	85mm mounting centers	No blown fuse indication	308
2056122		W/fitting for microswitch	
2056320	2X85mm mounting centers	No blown fuse indication	310
2056322		W/fitting for microswitch	
000 BS 70			
2055920	70mm mounting centers	No blown fuse indication	312
2055921		Blown Fuse indication	
2055922		W/fitting for microswitch	
Accessories			
Microswitch			
5805304	Clip Set for Indicator Fuse		314
5805307	Indicator Fuse		
5805404	Clip Set for Indicator Fuse		
5807307	Indicator Fuse		
5805305.1	Indicator Fuse		

URE	Rated Voltage [Un] 240V _{AC} 150V _{DC}	Rated Breaking Test Capacity 100kA 30kA	Class aR	Standard(s) BS 88-4 IEC 60 269-4 VDE 0636 Part 40
------------	--------------------------------------------------------------------------	---------------------------------------------------------	--------------------	-------------------------------------------------------------------

8.4mmx38mm - SLCT

Rated Current I_n [A]	Article Number	Power Loss [W]	Pre-arcing I^2t [A ² s]	Total I^2t @ 240V _{AC} [A ² s]
5	5007606.5	1.5	1.7	9.5
6	5007606.6	1.7	2.9	18
10	5007606.10	3.3	4.2	24
12	5007606.12	2.0	8.0	41
16	5007606.16	2.4	19	92
20	5007606.20	3.3	25	110

Weight [kg/1]	0.005
Units per Package	50

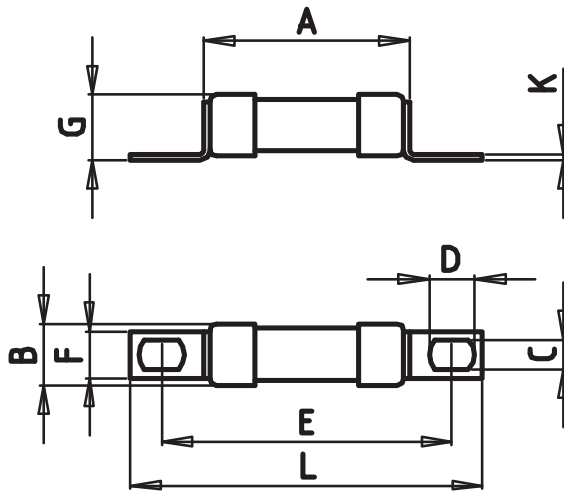

	Dimensions in / mm
A	1.06 / 27
B	0.33 / 8.4
C	0.16 / 4
D	0.24 / 6
E	1.50 / 38
F	0.25 / 6.4
G	0.35 / 9
K	0.03 / 0.8
L	1.8 / 46

5007606

URE	Rated Voltage	Rated Breaking Test Capacity	Class	Standard(s)
	[Un]	Voltage	aR	BS 88-4
	240V _{AC} 150V _{DC}	100kA 30kA	240V _{AC} 150V _{DC}	IEC 60 269-4 VDE 0636 Part 40
8.4mmx38mm -SLCT				

Coefficients for Heavy Duty Applications					
a	A2	B1	B2	Cf3	N
130	0.55	1.25	0.8	0.8	1.5

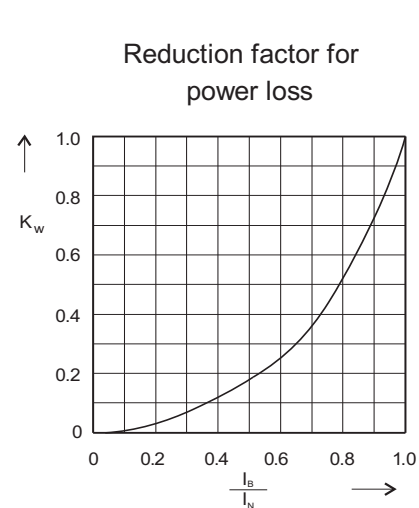
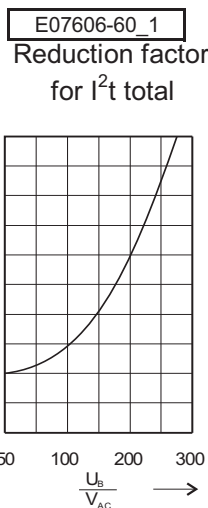
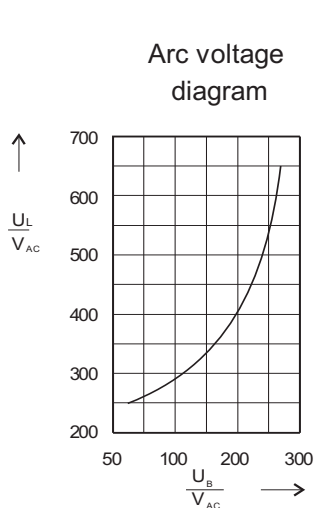
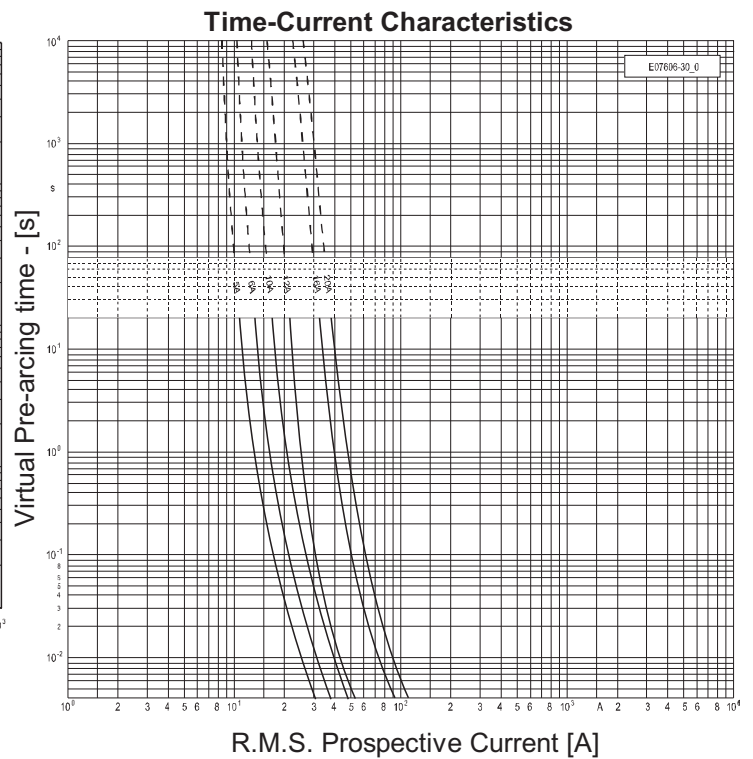
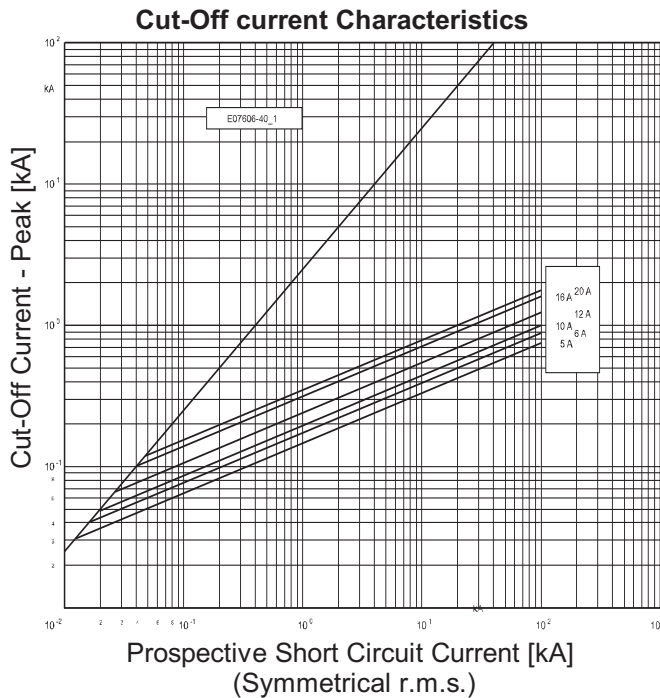

URE	Rated Voltage [Un] 240V _{AC} 150V _{DC}	Rated Breaking Test Capacity 100kA 30kA	Class aR	Standard(s) BS 88-4 IEC 60 269-4 VDE 0636 Part 40
Size 17.5mmx40mm - SLET				

Rated Current I _n [A]	Article Number	Power Loss [W]	Pre-arcing I ² t [A ² s]	Total I ² t @ 240V _{AC} [A ² s]
25	5005306.25	3.6	39	260
32	5005306.32	4.5	40	270
35	5005306.35	5.0	63	430
40	5005306.40	5.3	100	700
50	5005306.50	6.7	130	900
63	5005306.63	7.7	250	1 700
75	5005306.75	9.4	330	2 300
80	5005306.80	9.7	420	2 900
100	5005306.100	12.7	620	4 300
125	5005306.125	16.0	1 000	6 800
160	5005306.160	22.0	1 500	10 200
180	5005306.180	24.0	2 300	15 700

Weight [kg/1]
0.032
Units per Package
10

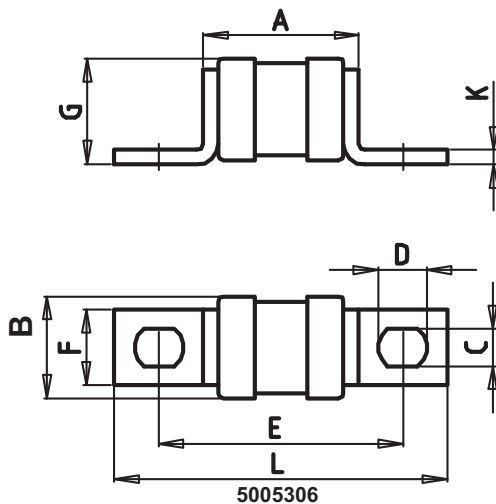

	Dimensions in / mm
A	1.02 / 26
B	0.70 / 17.5
C	0.25 / 6.35
D	0.30 / 8
E	1.57 / 40
F	0.50 / 13
G	0.73 / 18.5
K	0.10 / 2.5
L	2.17 / 55

Accessories

Article No.	Description	Page
5805304	Fuse Clips for Indicator	314
5805307	Fuse Indicator	
5805305.1	Microswitch	

URE	Rated Voltage	Rated Breaking Test Capacity	Class	Standard(s)
	[Un]	Voltage	aR	BS 88-4
	240V _{AC} 150V _{DC}	100kA 30kA	240V _{AC} 150V _{DC}	IEC 60 269-4 VDE 0636 Part 40
17.5mmx40mm - SLET				

Coefficients for Heavy Duty Applications					
a	A2	B1	B2	Cf3	N
130	0.55	1.25	0.8	0.8	1.5

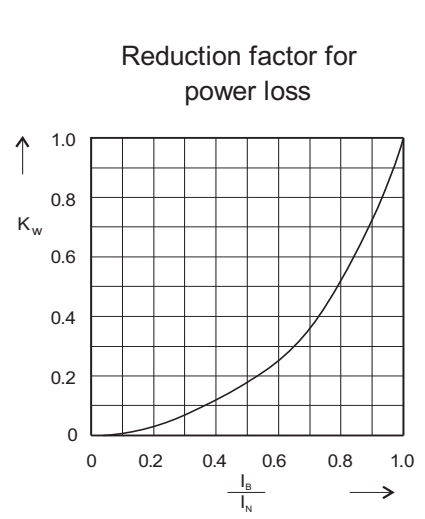
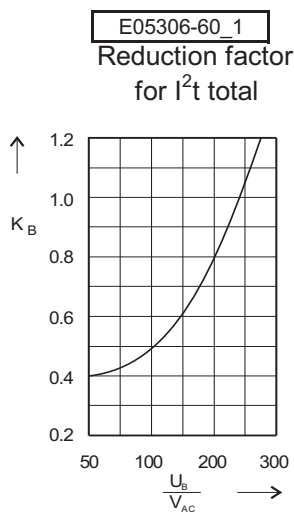
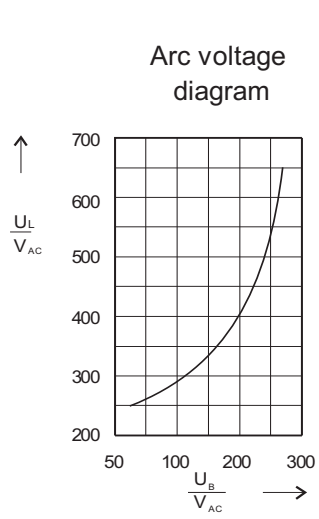
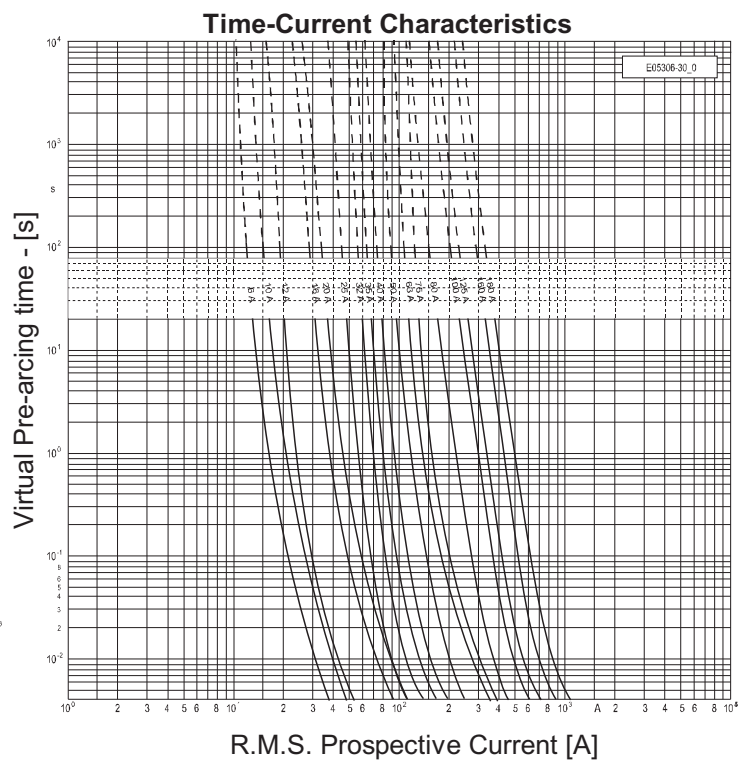
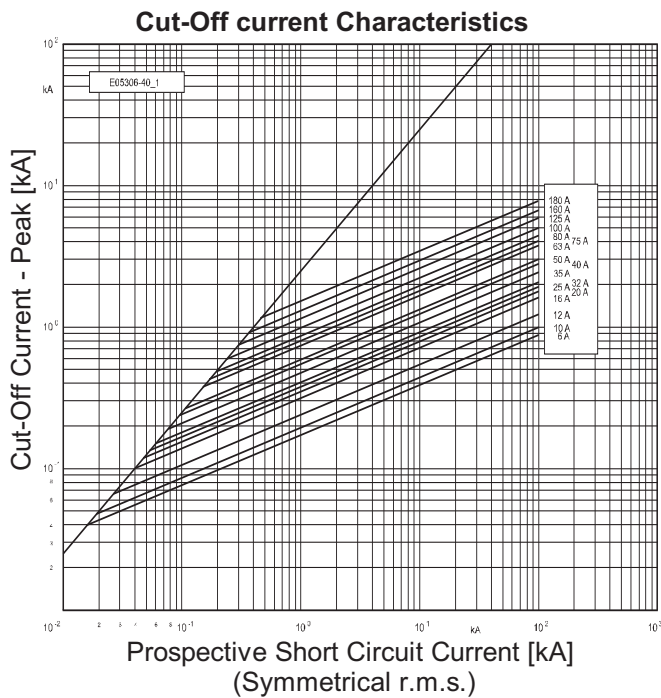

URE	Rated Voltage	Rated Breaking Test	Class	Standard(s)
	[Un]	Capacity	aR	BS 88-4
	240V _{AC} 150V _{DC}	100kA 30kA	240V _{AC} 150V _{DC}	IEC 60 269-4 VDE 0636 Part 40
35mmx59mm - SLMT				

Rated Current I _n [A]	Article Number	Power Loss [W]	Pre-arcing I ² t [A ² s]	Total I ² t @ 240V _{AC} [A ² s]
160	5005406.160	23	1 300	8 000
200	5005406.200	27	2 500	15 300
250	5005406.250	34	4 600	28 000
315	5005406.315	36	7 800	48 000
355	5005406.355	38	11 800	72 000
400	5005406.400	40	18 500	113 000
450	5005406.450	46	26 600	163 000

Weight [kg/1]	0.15
Units per Package	2

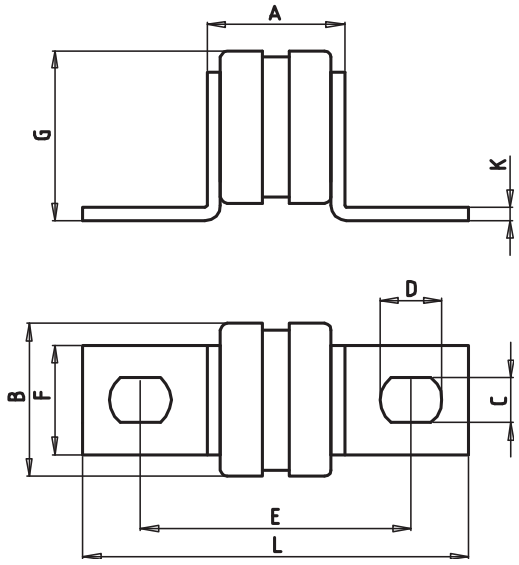

	Dimensions in / mm
A	1.22 / 31
B	1.38 / 35
C	0.40 / 10.3
D	0.53 / 13.5
E	2.32 / 59
F	0.98 / 25
G	1.54 / 39
K	0.12 / 3
L	3.30 / 84

5005406

Accessories

Article No.	Description	Page
5805404	Fuse Clips for Indicator	314
5805307	Fuse Indicator	
5805305.1	Microswitch	

URE	Rated Voltage	Rated Breaking Test Capacity	Class	Standard(s)
	[Un] 240V _{AC} 150V _{DC}	100kA 30kA	aR	BS 88-4 IEC 60 269-4 VDE 0636 Tiel 40
35mmx59mm - SLMT				

Coefficients for Heavy Duty Applications					
a	A2	B1	B2	Cf3	N
130	0.55	1.25	0.8	0.8	1.5

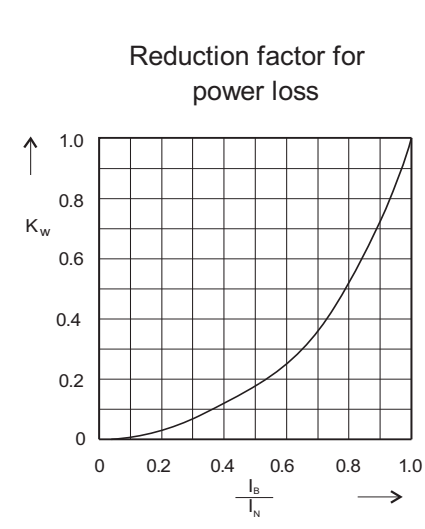
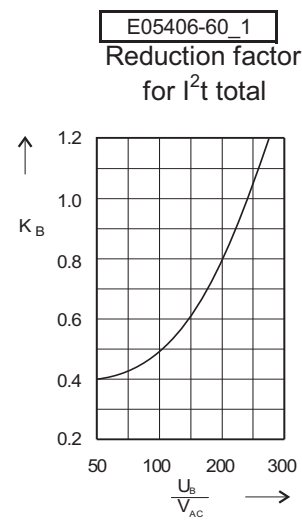
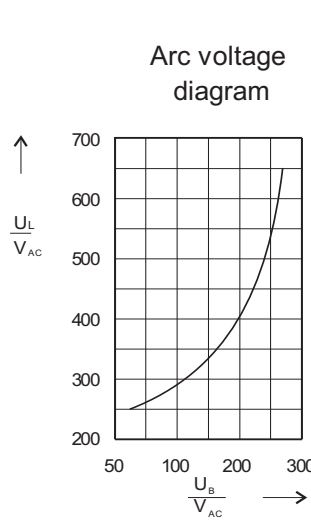
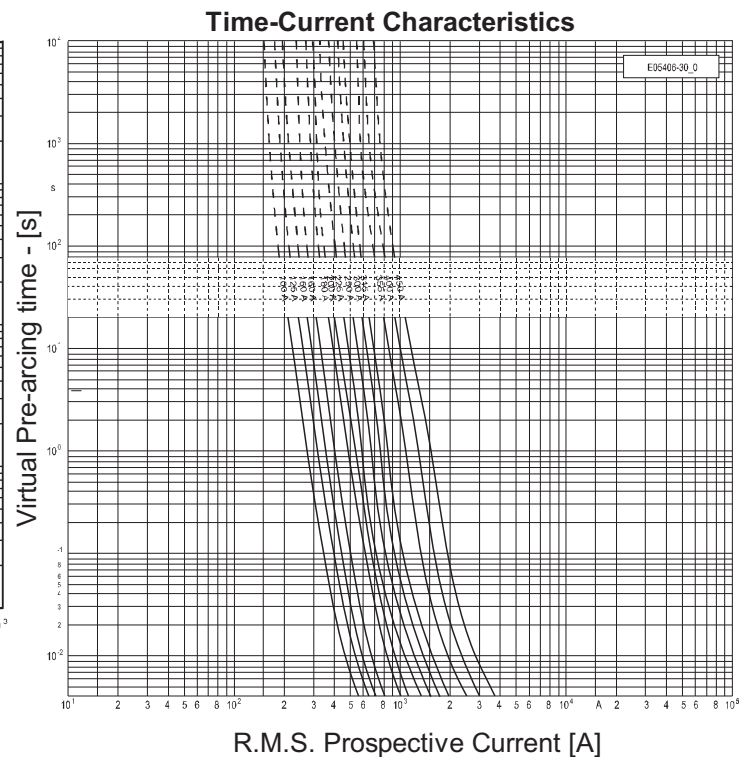
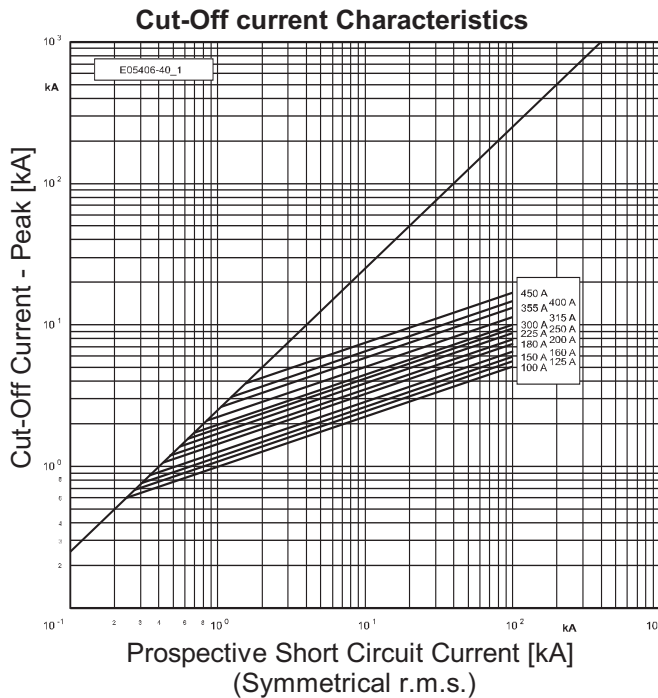

URE	Rated Voltage	Rated Breaking Test Capacity	Class	Standard(s)
	[Un]	Capacity	aR	BS 88-4
	240V _{AC}	100kA	240V _{AC}	IEC 60 269-4
	150V _{DC}	30kA	150V _{DC}	VDE 0636 Part 40
2X35mmx59mm - SLMMT				

Rated Current I _n [A]	Article Number	Power Loss [W]	Pre-arcing I ² t [A ² s]	Total I ² t @ 240V _{AC} [A ² s]
300	5007106.300	47	5 300	32 000
350	5007106.350	51	8 200	50 000
400	5007106.400	55	10 000	61 000
450	5007106.450	56	19 000	116 000
500	5007106.500	59	27 000	165 000
630	5007106.630	62	50 000	305 000
710	5007106.710	72	70 000	427 000
800	5007106.800	74	106 000	647 000
900	5007106.900	90	150 000	915 000

Weight [kg/1]
0.29
Units per Package
1

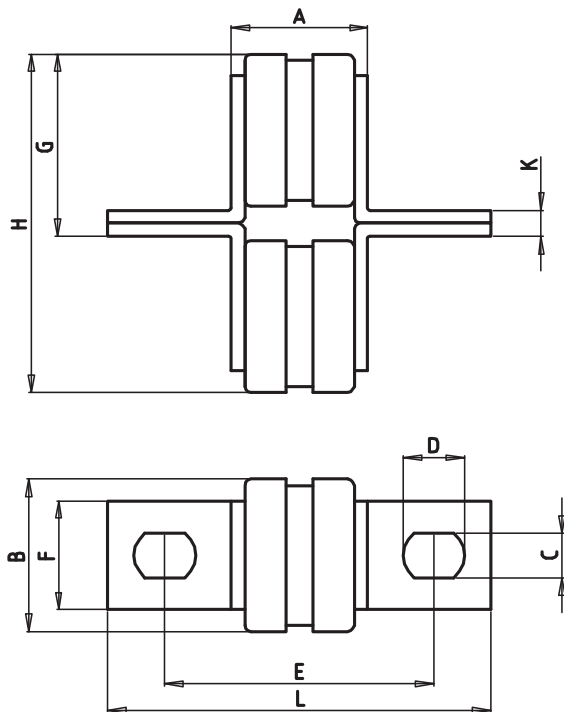

	Dimensions in / mm
A	1.22 / 31
B	1.38 / 35
C	0.40 / 10.3
D	0.53 / 13.5
E	2.32 / 59
F	0.98 / 25
G	1.65 / 42
H	3.07 / 78
K	0.12 / 3
L	3.30 / 84

5007106

Accessories

Article No.	Description	Page
5805404	Fuse Clips for Indicator	314
5805307	Fuse Indicator	
5805305.1	Microswitch	

URE	Rated Voltage	Rated Breaking Test	Class	Standard(s)
	[Un]	Capacity	aR	BS 88-4
	240V _{AC}	100kA	240V _{AC}	IEC 60 269-4
	150V _{DC}	30kA	150V _{DC}	VDE 0636 Part 40
2X35mmx59mm - SLMMT				

Coefficients for Heavy Duty Applications					
a	A2	B1	B2	Cf3	N
130	0.55	1.25	0.5	0.8	1.5

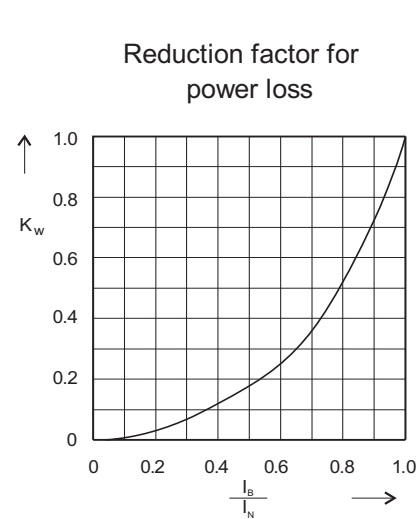
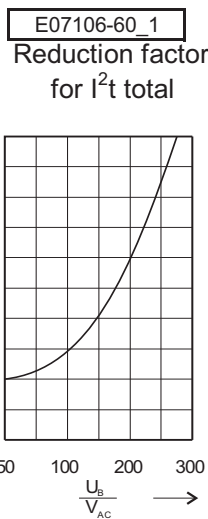
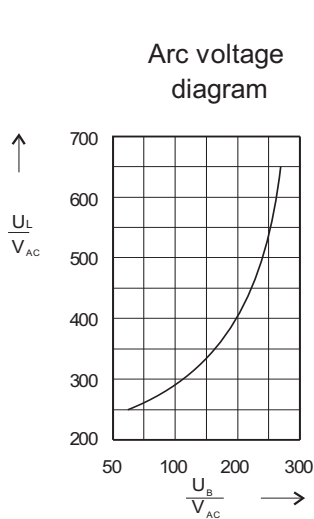
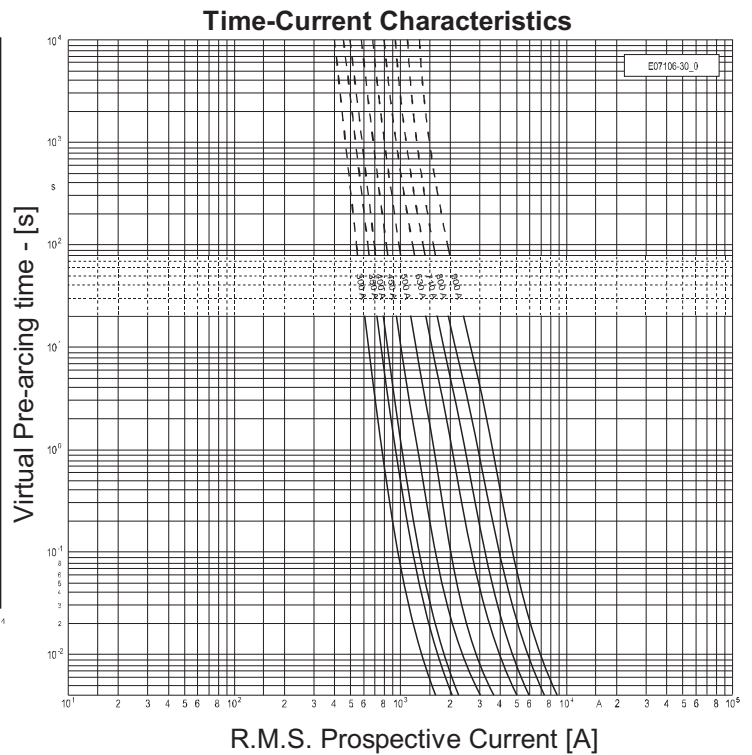
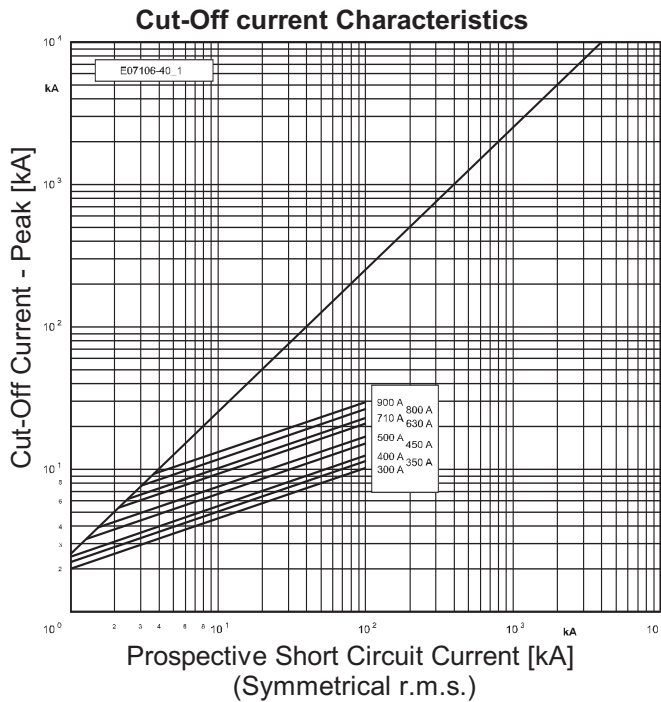

URE	Rated Voltage	Rated Breaking Test Capacity	Class	Standard(s)
	[Un]	Capacity	aR	BS 88-4
	690V _{AC}	100kA	690V _{AC}	IEC 60 269-4
	450V _{DC}	30kA	450V _{DC}	VDE 0636 Part 40
8.4mmx64mm - SCT				

Rated Current I_n [A]	Article Number	Power Loss [W]	Pre-arcing I^2t [A ² s]	Total I^2t @ 690V _{AC} [A ² s]
5	5007706.5	1.5	1.7	9.5
6	5007706.6	1.7	2.9	18
10	5007706.10	3.3	4.2	24
12	5007706.12	2.0	8.0	41
16	5007706.16	2.4	19	92
20	5007706.20	3.3	25	110

Weight [kg/1]	0.008
Units per Package	50

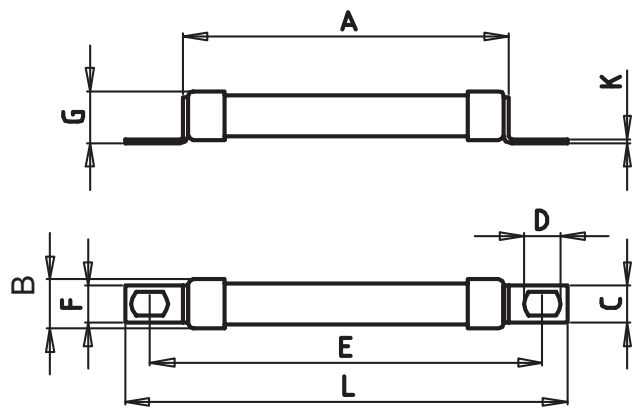

	Dimensions in / mm
A	2.11 / 53.5
B	0.33 / 8.4
C	0.16 / 4
D	0.24 / 6
E	2.53 / 64.3
F	0.25 / 6.4
G	0.35 / 9
K	0.03 / 0.8
L	2.87 / 73

5007706

URE	Rated Voltage	Rated Breaking Test Capacity	Class	Standard(s)
	[Un]	Voltage	aR	BS 88-4
	690V _{AC} 450V _{DC}	100kA 30kA	690V _{AC} 450V _{DC}	IEC 60 269-4 VDE 0636 Part 40
8.4mmx64mm - SCT				

Coefficients for Heavy Duty Applications					
a	A2	B1	B2	Cf3	N
130	0.55	1.25	0.5	0.8	1.5

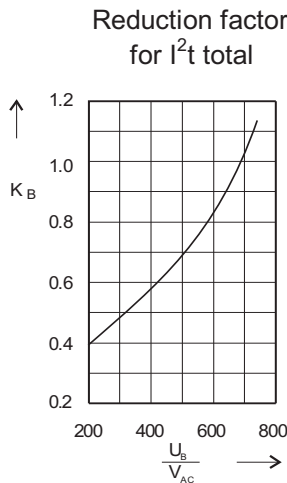
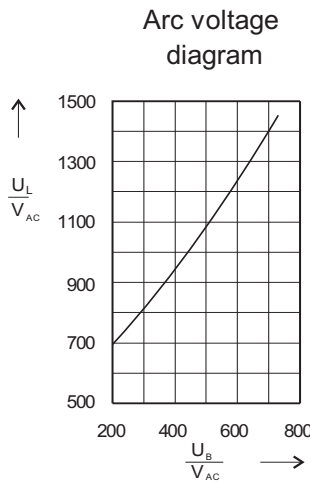
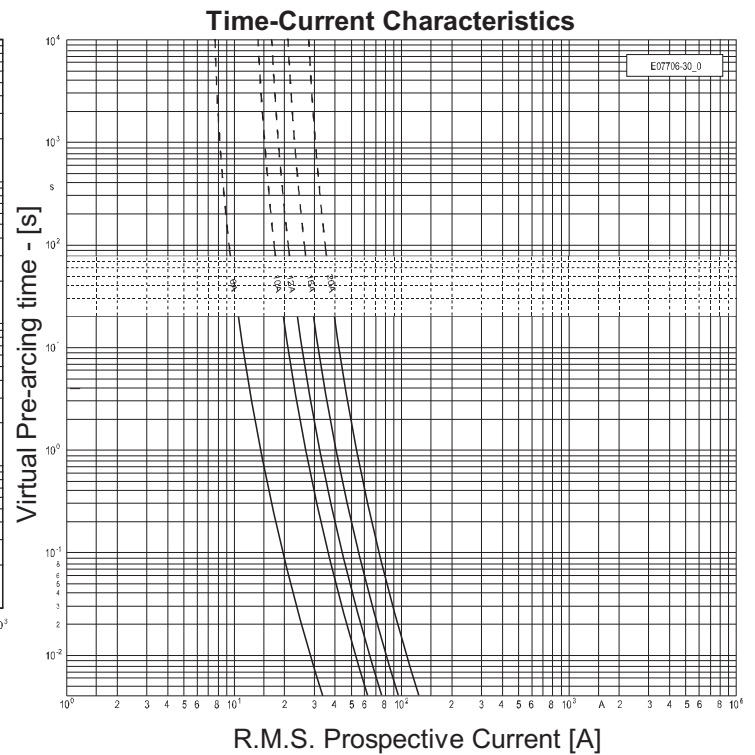
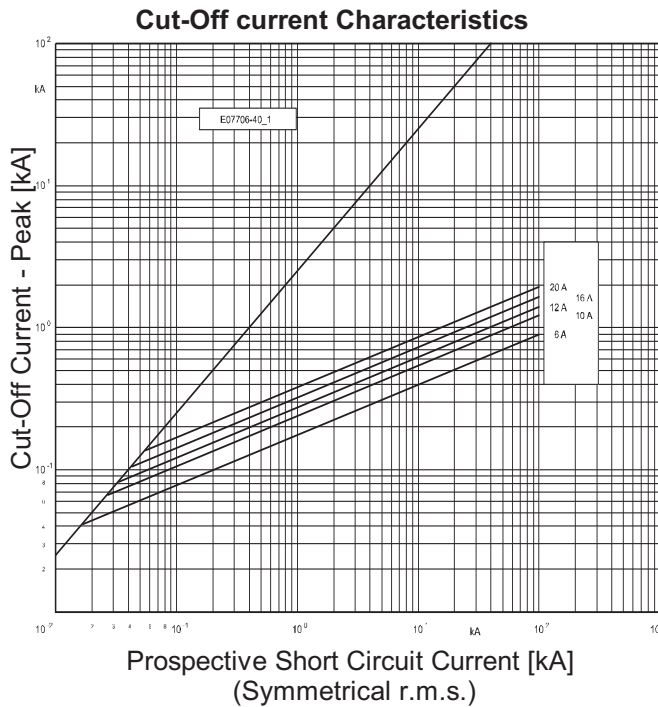

URE	Rated Voltage [Un] 690V _{AC}	Rated Breaking Test Capacity 100kA	Class aR	Standard(s) BS 88-4 IEC 60 269-4 VDE 0636 Part 40
------------	----------------------------------------------------	-------------------------------------------------	--------------------	-------------------------------------------------------------------

17.5mmx63mm - SFE

Rated Current I_n [A]	Article Number	Power Loss [W]	Pre-arcing I^2t [A ² s]	Total I^2t @ 690V _{AC} [A ² s]
25	5007306.25	7	25	110
32	5007306.32	9	50	210
35	5007306.35	10	60	260
40	5007306.40	11	80	330
50	5007306.50	12	190	780
63	5007306.63	15	290	1 200
80	5007306.80	18	420	1 700
100	5007306.100	23	740	3 100

Weight [kg/1]
0.042
Units per Package
10

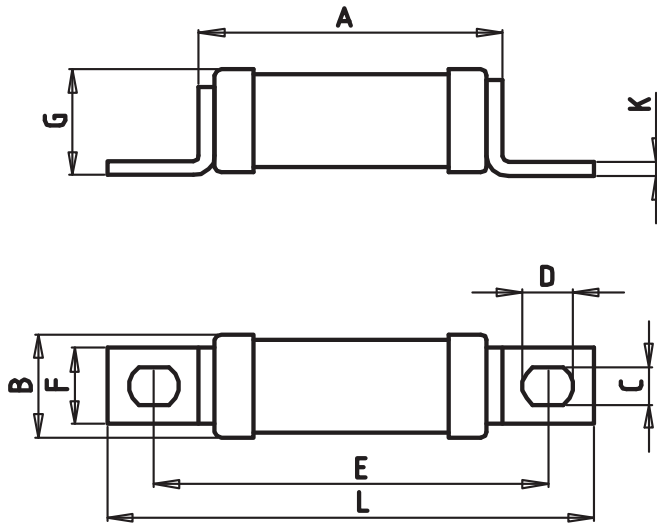

	Dimensions in / mm
A	1.90 / 48
B	0.70 / 17.5
C	0.25 / 6.35
D	0.30 / 8
E	2.48 / 63
F	0.50 / 13
G	0.73 / 18.5
K	0.10 / 2.5
L	3.03 / 77

5007306

Accessories

Article No.	Description	Page
5805304	Fuse Clips for Indicator	314
5807307	Fuse Indicator	
5805305.1	Microswitch	

URE	Rated Voltage	Rated Breaking Test Capacity	Class	Standard(s)
	[Un] 690V _{AC}	100kA	aR 690V _{AC} 450V _{DC}	BS 88-4 IEC 60 269-4 VDE 0636 Part 40
17.5mmx63mm - SFE				

Coefficients for Heavy Duty Applications					
a	A2	B1	B2	Cf3	N
130	0.6	1.25	0.6	0.8	1.5

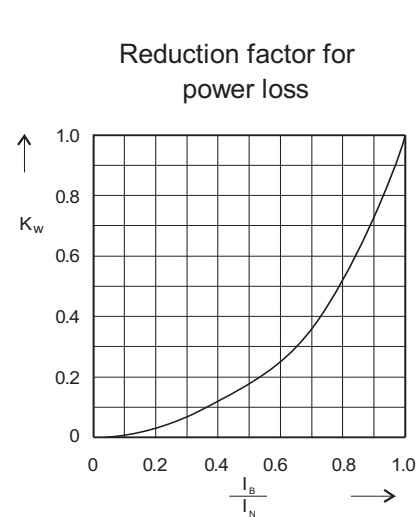
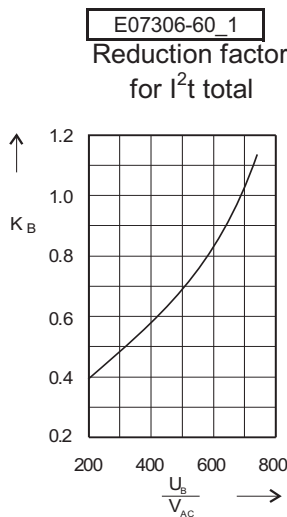
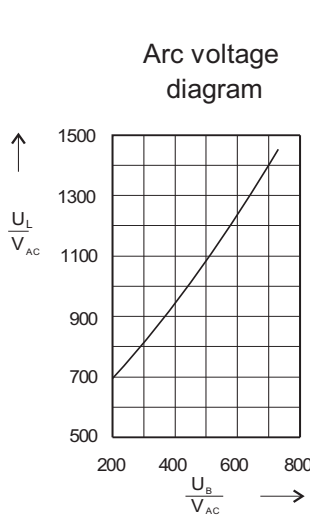
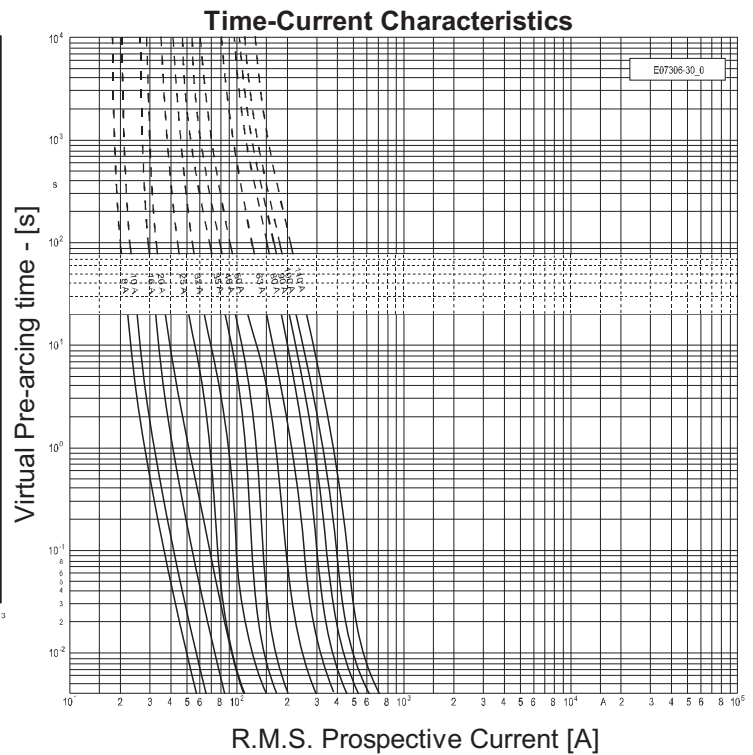
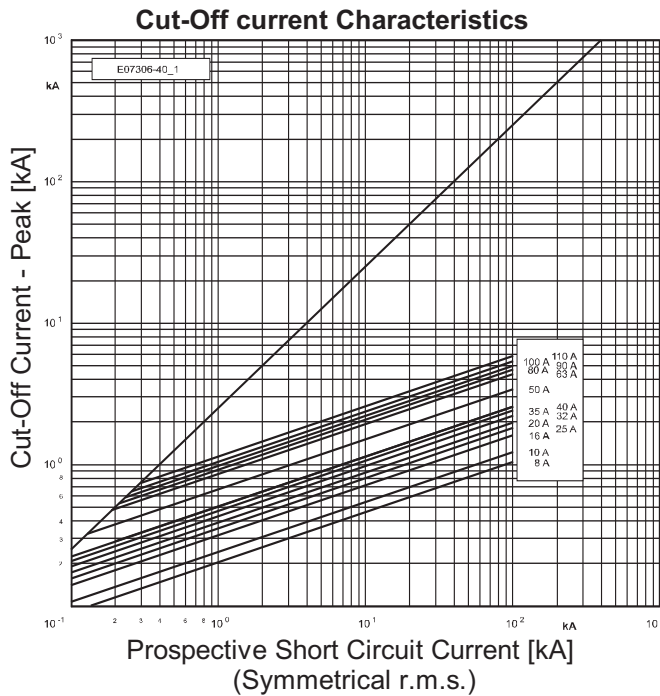

URE	Rated Voltage [Un] 690V _{AC} 450V _{DC}	Rated Breaking Test Capacity 100kA 30kA	Class aR	Standard(s) BS 88-4 IEC 60 269-4 VDE 0636 Part 40
------------	--------------------------------------------------------------------------	---------------------------------------------------------	--------------------	-------------------------------------------------------------------

35mmx80mm - SMT

Rated Current I _n [A]	Article Number	Power Loss [W]	Pre-arcing I ² t [A ² s]	Total I ² t @ 690V _{AC} [A ² s]
100	5007406.100	22	1 000	6 500
125	5007406.125	29	1 700	11 000
160	5007406.160	30	4 000	26 000
200	5007406.200	31	9 000	58 000
250	5007406.250	40	18 000	116 000
315	5007406.315	44	27 000	173 000
355	5007406.355	56	36 000	231 000

Weight [kg/1]
0.19
Units per Package
3

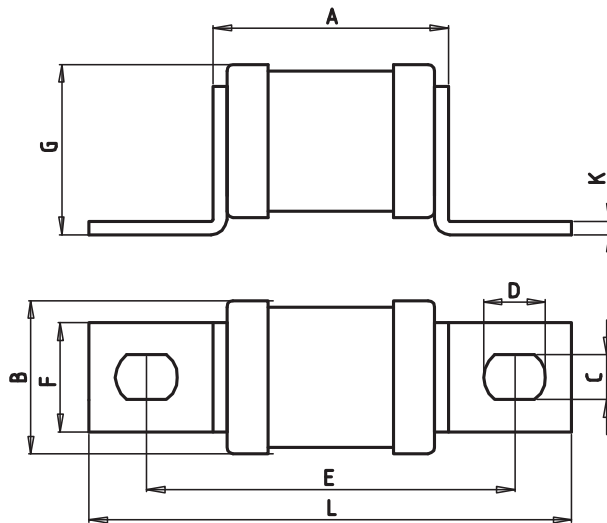

	Dimensions in / mm
A	2.05 / 52
B	1.38 / 35
C	0.40 / 10.3
D	0.53 / 13.5
E	3.15 / 80
F	0.98 / 25
G	1.54 / 39
K	0.12 / 3
L	4.13 / 105

5007406

Accessories

Article No.	Description	Page
5805404	Fuse Clips for Indicator	314
5807307	Fuse Indicator	
5805305.1	Microswitch	

URE	Rated Voltage	Rated Breaking Test	Class	Standard(s)
	[Un]	Capacity	aR	BS 88-4
	690V _{AC} 450V _{DC}	100kA 30kA	690V _{AC} 450V _{DC}	IEC 60 269-4 VDE 0636 Tiel 40
35mmx80mm - SMT				

Coefficients for Heavy Duty Applications					
a	A2	B1	B2	Cf3	N
130	0.6	1.25	0.6	0.8	1.5

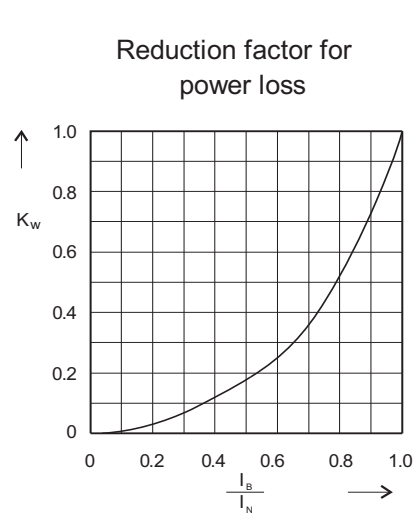
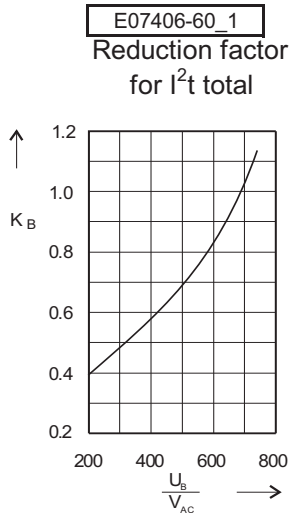
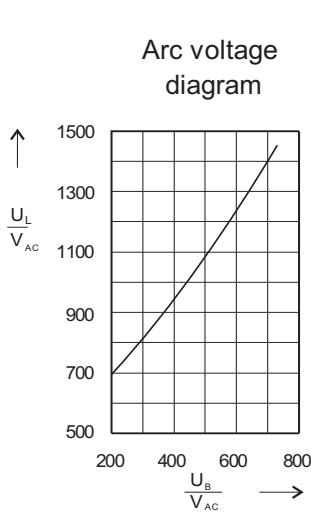
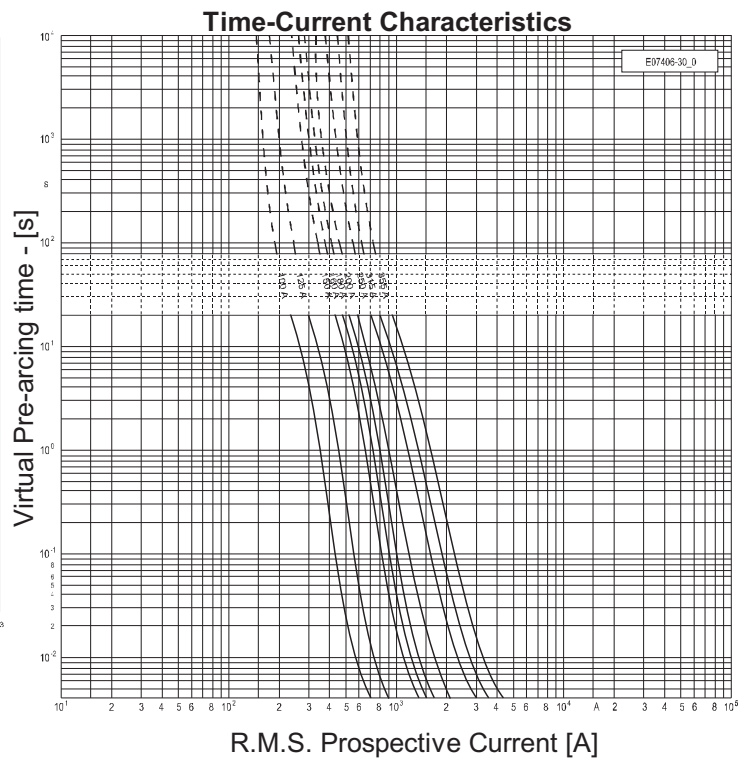
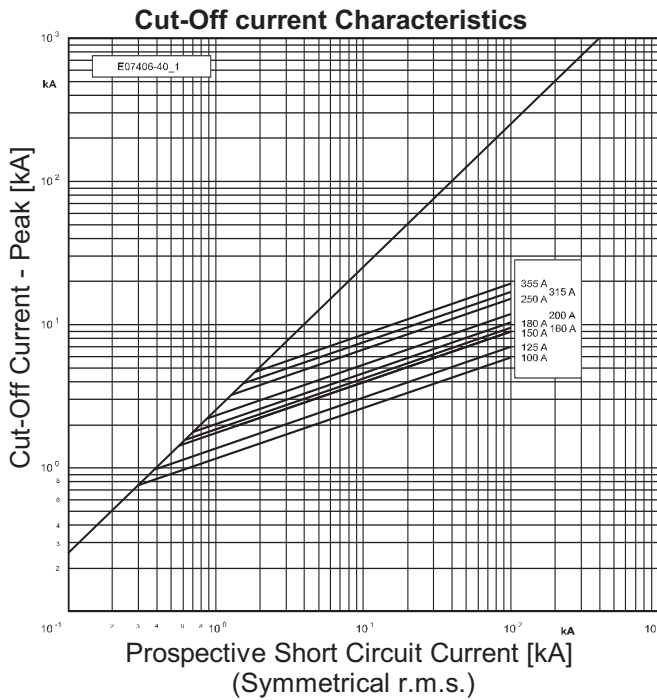

URE	[Un]	Capacity	Voltage	aR	BS 88-4
	690V_{AC}	100kA	690V_{AC}		IEC 60 269-4
	450V_{DC}	30kA	450V_{DC}		VDE 0636 Part 40
2X35mmx80mm - SMMT					

Rated Current I_n [A]	Article Number	Power Loss [W]	Pre-arcing I^2t [A ² s]	Total I^2t @ 690V _{AC} [A ² s]
315	5007506.315	48	18 500	119 000
355	5007506.355	55	22 300	143 000
400	5007506.400	58	26 100	167 000
450	5007506.450	63	52 300	335 000
500	5007506.500	68	70 100	449 000
630	5007506.630	87	106 000	679 000
710	5007506.710	104	145 000	928 000

Weight [kg/1]	0.37
Units per Package	1

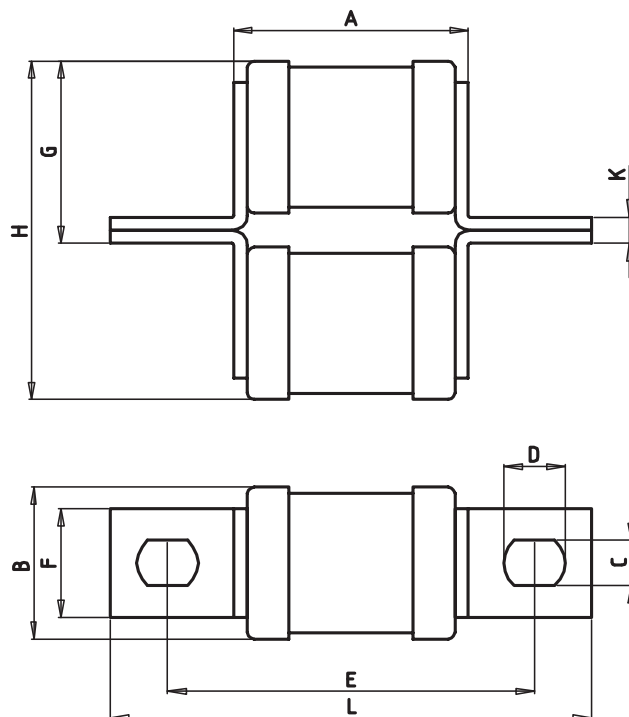

	Dimensions in / mm
A	2.05 / 52
B	1.38 / 35
C	0.40 / 10.3
D	0.53 / 13.5
E	3.15 / 80
F	0.98 / 25
G	1.65 / 42
H	3.07 / 78
K	0.24 / 6
L	4.12 / 105

5007506

Accessories

Article No.	Description	Page
5805407	Fuse Clips for Indicator	314
5807307	Fuse Indicator	
5805305.1	Microswitch	

URE	Rated Voltage	Rated Breaking Test Capacity	Class	Standard(s)
	[Un]	Voltage	aR	BS 88-4
	690V _{AC} 450V _{DC}	100kA 30kA	690V _{AC} 450V _{DC}	IEC 60 269-4 VDE 0636 Part 40
2X35mmx80mm - SMT				

Coefficients for Heavy Duty Applications					
a	A2	B1	B2	Cf3	N
130	0.55	1.25	0.6	0.8	1.5

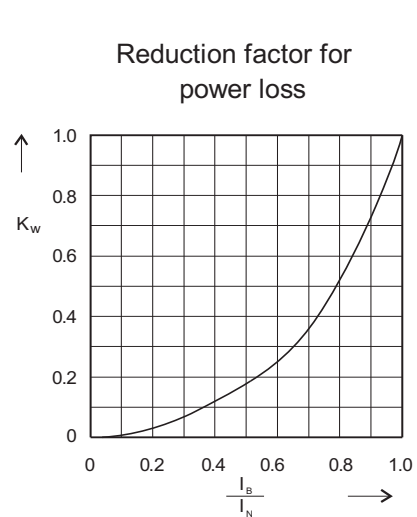
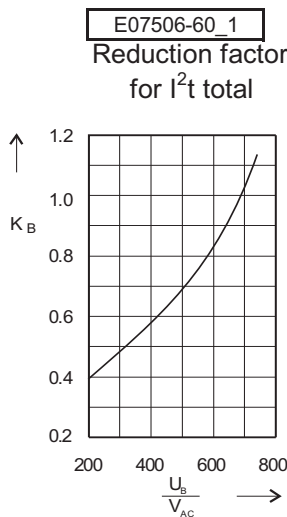
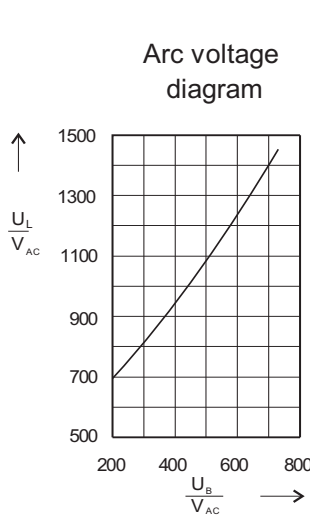
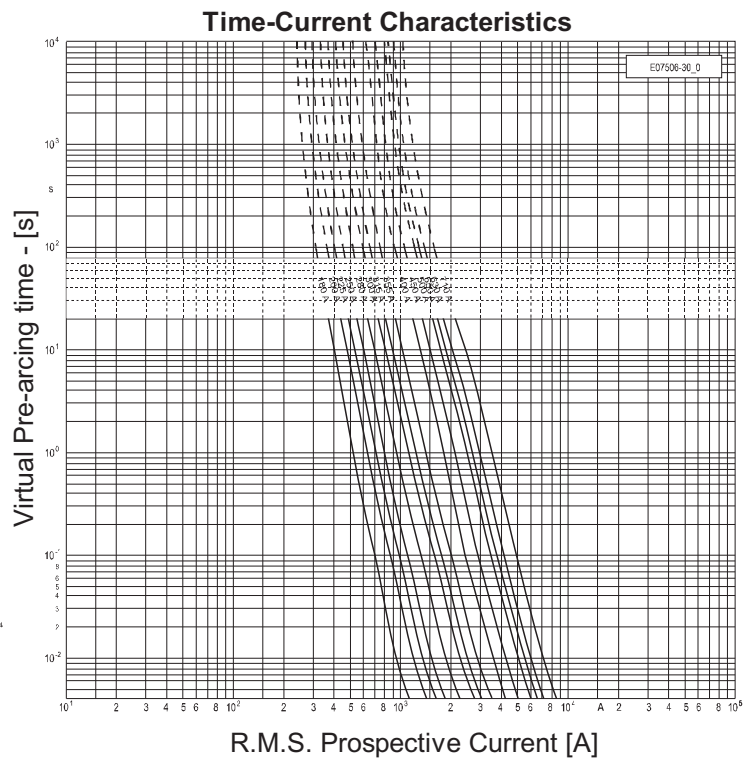
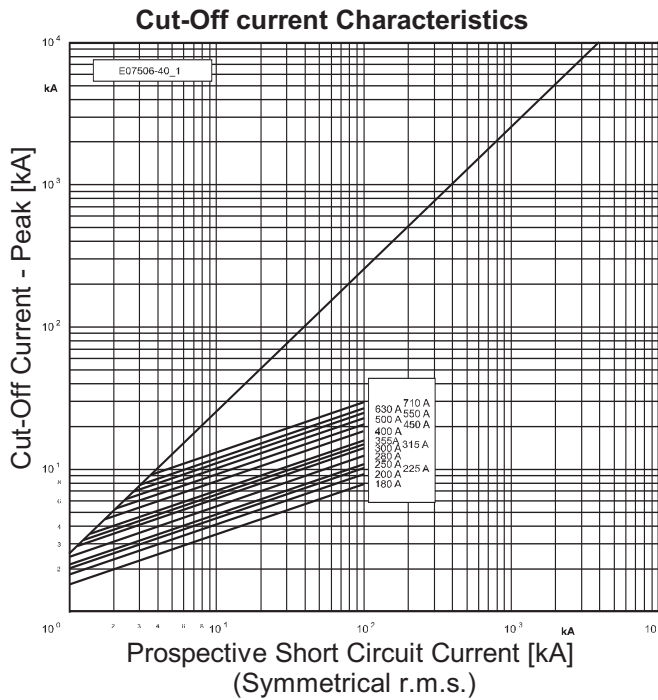

URE	Rated Voltage [Un] 690V_{AC}	Rated Breaking Test Capacity 120kA	Class aR	Standard(s) BS 88-4 IEC 60 269-4 VDE 0636 Part 40
Size 000 DIN 85				

Rated Current I_n [A]	Without Indicator Article Number	With Indicator and Fitting for Microswitch Article Number		Power Loss [W]	Pre-arcing I^2t [A ² s]	Total I^2t @ 690V _{AC} [A ² s]
110	2056120.110	2056122.110		21	1 350	6 000
125	2056120.125	2056122.125		22	2 000	8 900
150	2056120.150	2056122.150		24	3 300	14 000
160	2056120.160	2056122.160		27	3 700	16 000
180	2056120.180	2056122.180		30	5 400	23 000
200	2056120.200	2056122.200		31	11 200	47 000
250	2056120.250	2056122.250		32	14 900	63 000
280	2056120.280	2056122.280		44	17 000	70 000
300	2056120.300	2056122.300		48	18 000	73 000
315	2056120.315	2056122.315		50	19 200	77 000
350	2056120.350*	2056122.350		56	23 000	76 000
400	2056120.400*	2056122.400		70	32 100	101 000

Weight (kg per 1)		*500V _{AC}
0.19	0.19	
Units per Package		
6	6	

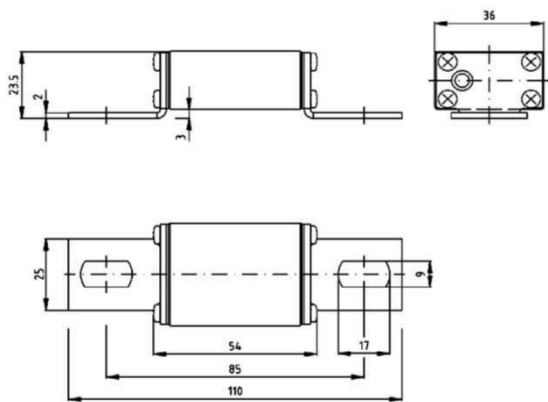

2056120

Dimensions
in / mm
0.08 / 2
0.35 / 9
0.47 / 12
0.93 / 23.5
1.26 / 32
1.42 / 36
2.13 / 54
3.35 / 85
4.33 / 110
1.50 / 38
2.01 / 51

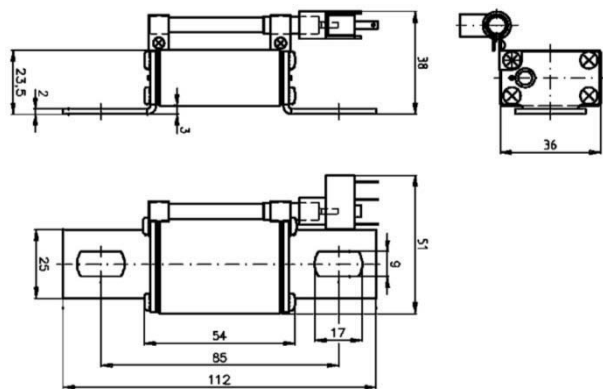

2056122

Accessories

Article No.	Description	Page

URE	Rated Voltage	Rated Breaking Test Capacity	Class	Standard(s)
	[Un] 690V _{AC}	120kA	aR	BS 88-4 IEC 60 269-4 VDE 0636 Part 40
Size 000 DIN 85				

Coefficients for Heavy Duty Applications					
a	A2	B1	B2	Cf3	N
130	0.55	1.25	0.6	0.8	1.5

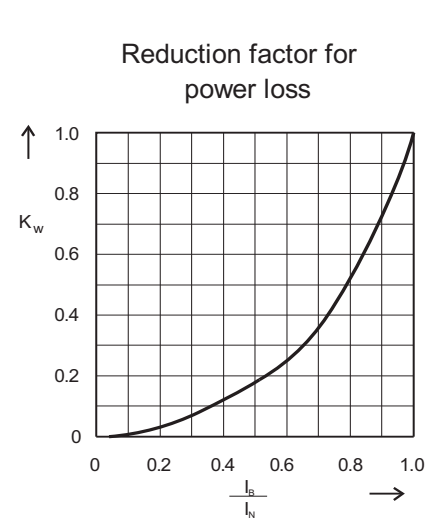
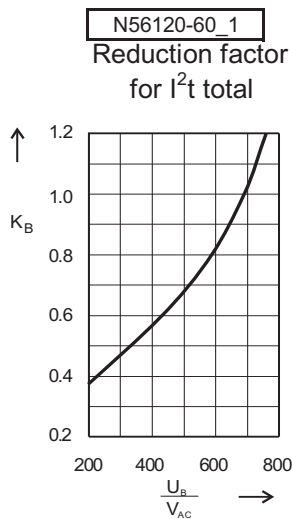
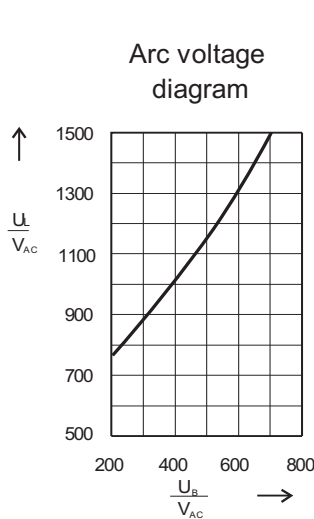
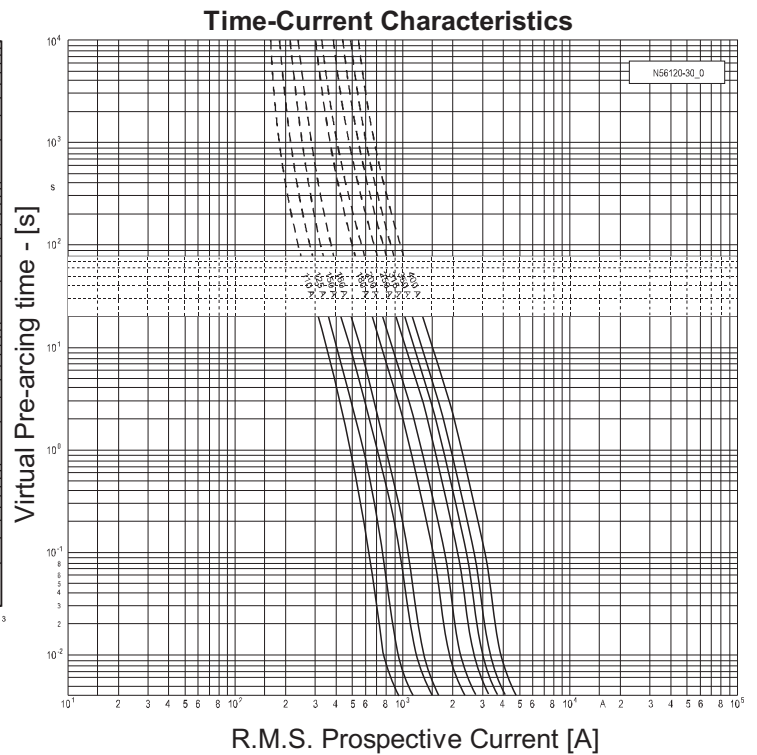
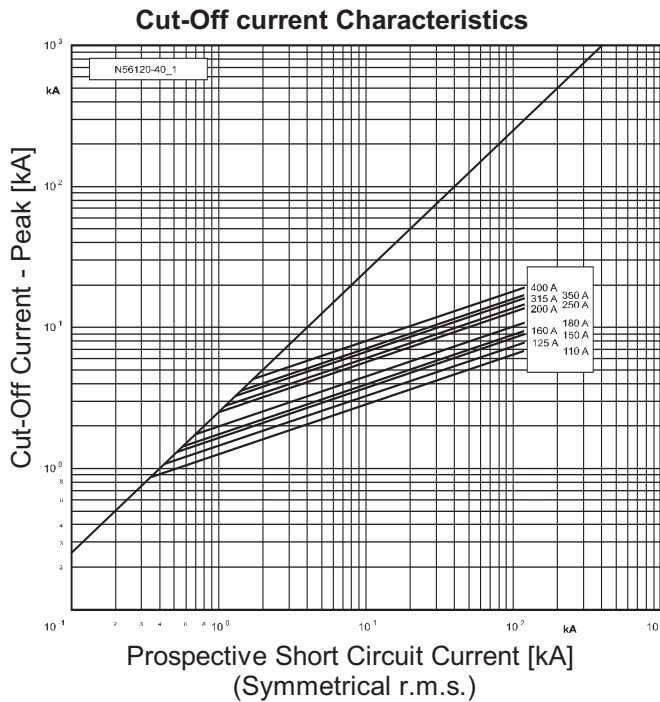

URE	Rated Voltage [Un] 690V _{AC}	Rated Breaking Test Capacity 120kA	Class aR	Standard(s) BS 88-4 IEC 60 269-4 VDE 0636 Part 40
------------	----------------------------------------------------	----------------------------------------------	--------------------	-------------------------------------------------------------------

Size 2X000 DIN 85

Rated Current I _n [A]	Without Indicator Article Number	With Indicator and Fitting for Microswitch Article Number		Power Loss [W]	Pre-arcing I ² t [A ² s]	Total I ² t @ 690V _{AC} [A ² s]
400	2056320.400	2056322.400		65	44 800	188 000
450	2056320.450	2056322.450		68	52 000	220 000
500	2056320.500	2056322.500		69	59 000	252 000
630	2056320.630	2056322.630		105	76 000	308 000
700	2056320.700*	2056322.700		118	95 000	304 000
800	2056320.800*	2056320.800		147	129 000	404 000
Weight (kg per 1)			*500V _{AC}			
0.38						
Units per Package						
3						

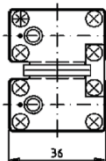
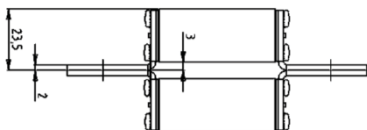

Dimensions
in / mm
0.08 / 2
0.35 / 9
0.47 / 12
0.93 / 23.5
1.26 / 32
1.42 / 36
2.13 / 54
3.35 / 85
4.33 / 110
1.50 / 38
2.01 / 51

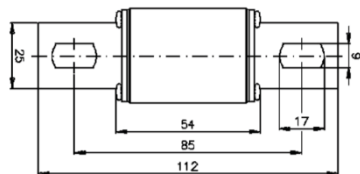
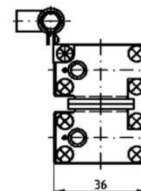
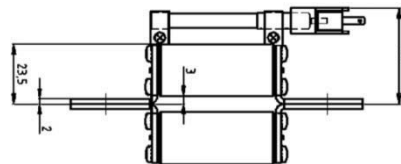

2056320

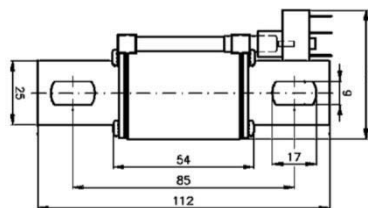

2056322

Accessories

Article No.	Description	Page

URE	Rated Voltage	Rated Breaking Test	Class	Standard(s)
	[Un] 690V _{AC}	Capacity 120kA	aR 690V _{AC}	BS 88-4 IEC 60 269-4 VDE 0636 Part 40
Size 2X000 DIN 85				

Coefficients for Heavy Duty Applications					
a	A2	B1	B2	Cf3	N
130	0.55	1.25	0.6	0.8	1.5

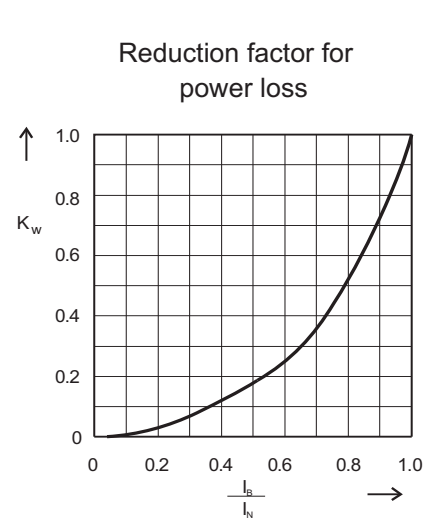
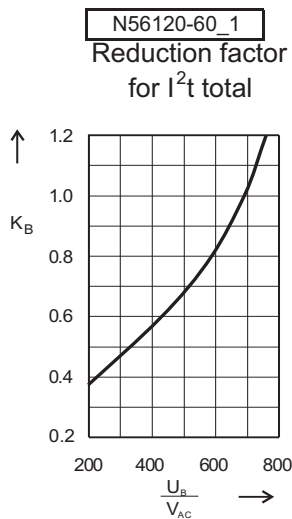
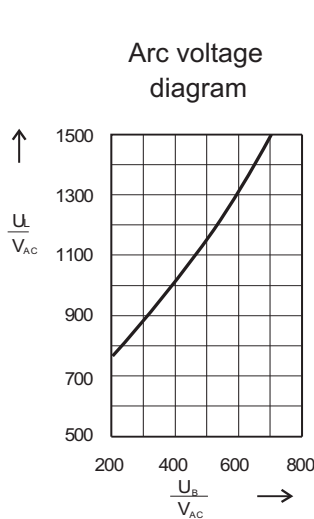
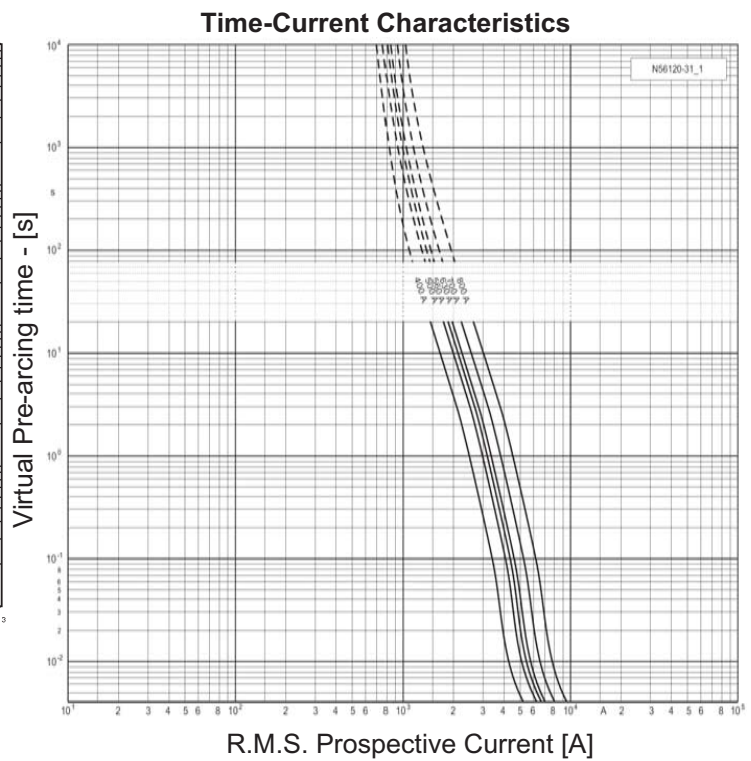
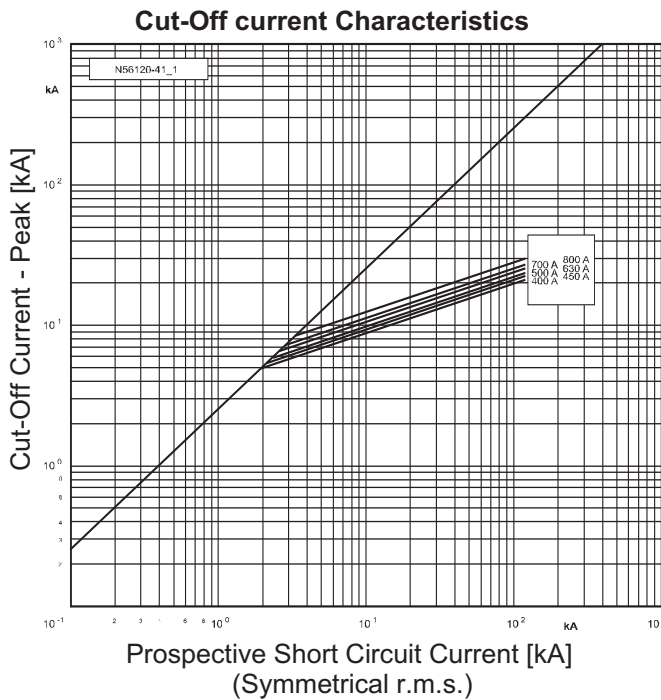

URE	Rated Voltage [Un] 690V_{AC}	Rated Breaking Test Capacity 120kA	Class aR	Standard(s) BS 88-4 IEC 60 269-4 VDE 0636 Part 40
------------	----------------------------------------------------------	-----------------------------------------------------	---------------------------	----------------------------------------------------------------------------------------

Size 000 BS 70

Rated Current I_n [A]	Without Indicator Article Number	With Indicator Article Number	With Indicator and Fitting for Microswitch Article Number	Power Loss [W]	Pre-arcing I^2t [A ² s]	Total I^2t @ 690V _{AC} [A ² s]
32	2055921.32	2055920.32	✓ 2055922.32	8	52	290
35	2055921.35	2055920.35	✓ 2055922.35	9	68	360
40	2055921.40	2055920.40	✓ 2055922.40	10	90	500
50	2055921.50	2055920.50	✓ 2055922.50	12	140	770
63	2055921.63	2055920.63	✓ 2055922.63	14	250	1 400
80	2055921.80	2055920.80	✓ 2055922.80	18	470	2 600
100	2055921.100	2055920.100	✓ 2055922.100	22	730	4 000
125	2055921.125	2055920.125	✓ 2055922.125	26	1 300	7 200
160	2055921.160	2055920.160	✓ 2055922.160	21	2 800	15 400
180	2055921.180	2055920.180	✓ 2055922.180	35	3 700	20 400
200	2055921.200	2055920.200	✓ 2055922.200	39	4 500	25 000
250	2055921.250	2055920.250	✓ 2055922.250	47	8 000	44 000
315	2055921.315	2055920.315	✓ 2055922.315	58	14 000	77 000

Weight (kg per 1)
0.17
Units per Package
6

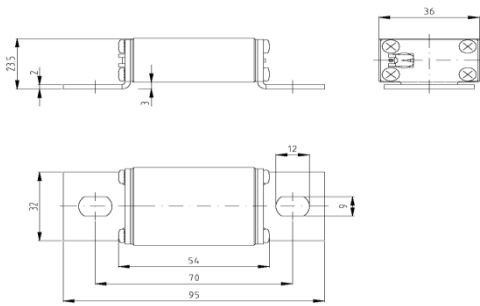

2055921 / 2055920

Dimensions	
in / mm	
0.08	/ 2
0.35	/ 9
0.47	/ 12
0.93	/ 23.5
1.26	/ 32
1.42	/ 36
2.13	/ 54
2.76	/ 70
3.74	/ 95
1.50	/ 38
2.01	/ 51

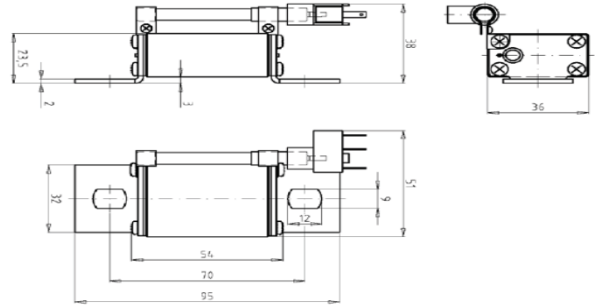

2055922

Accessories

Article No.	Description	Page

URE	Rated Voltage [Un] 690V _{AC}	Rated Breaking Test Capacity 120kA	Class aR	Standard(s) BS 88-4 IEC 60 269-4 VDE 0636 Part 40
Size 000 BS 70				

Coefficients for Heavy Duty Applications					
a	A2	B1	B2	Cf3	N
130	0.55	1.25	0.6	0.8	1.5

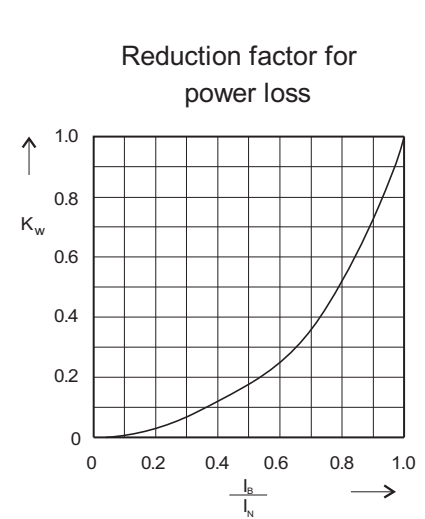
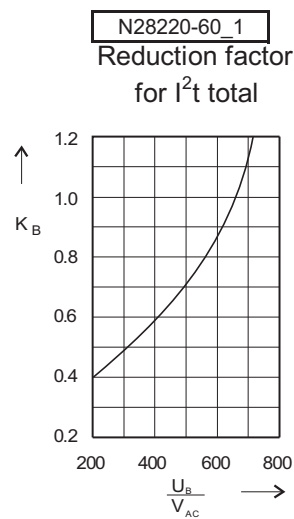
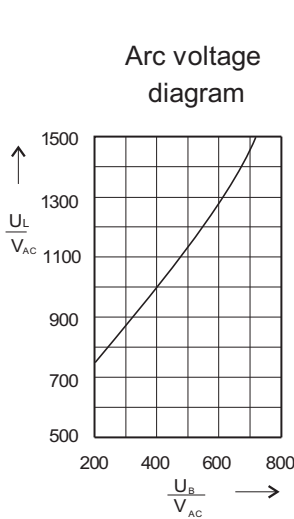
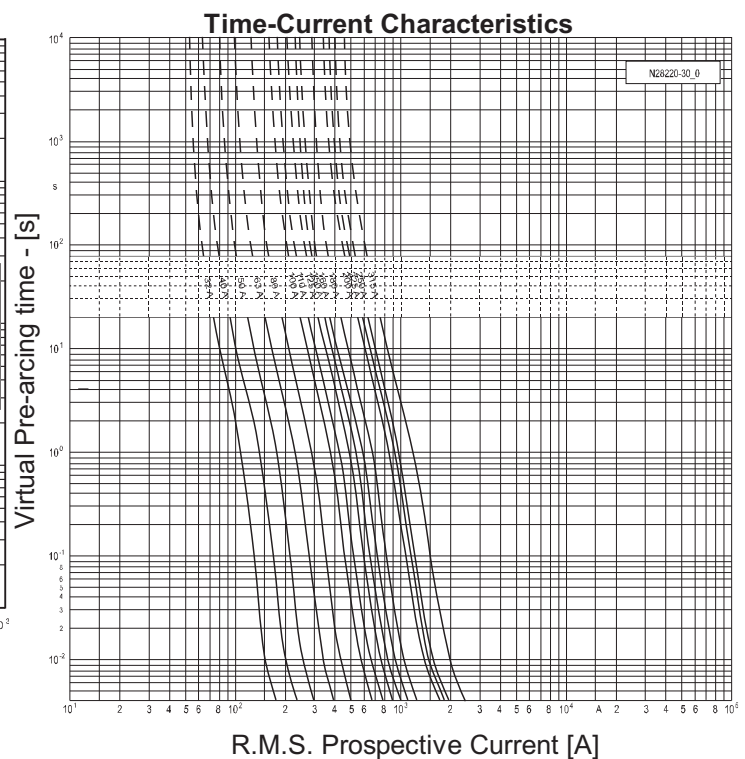
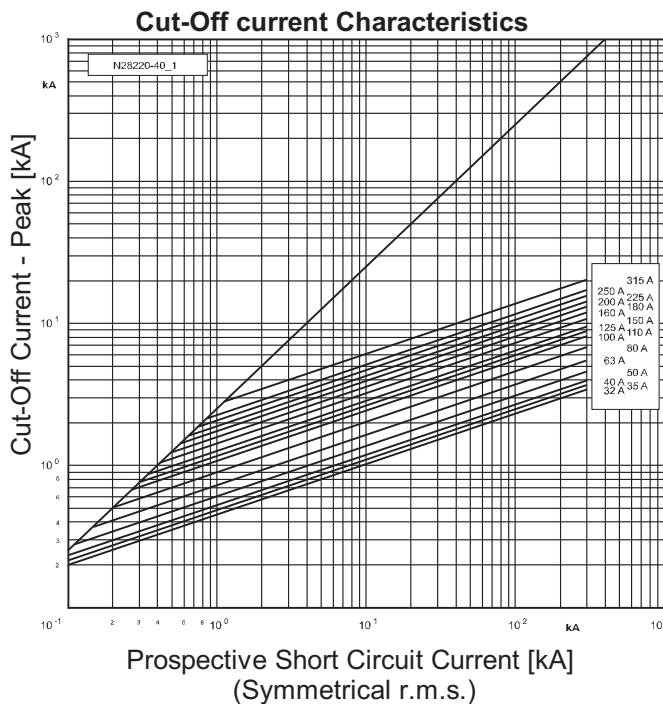

N28220-60_1

Accessories
Indicators and Microswitches

Article Number	I Clip Set for Indicator Fuse	II Indicator Fuse	III Microswitch	Dimensions [in/mm]		
				H	I	J
5005306	5805304	5805307	5805305.1	0.98 / 25	0.87 / 22	0.94 / 24
5005406	5805404	5805307		1.60 / 41	1.46 / 37	1.54 / 39
5007306	5805304	5807307		0.98 / 25	0.87 / 22	0.94 / 24
5007406	5805404	5807307		1.60 / 41	1.46 / 37	1.54 / 39
5007106	5805404	5805307		0.98 / 25	0.87 / 22	0.94 / 24
5007506	5805404	5807307		1.60 / 41	1.46 / 37	1.54 / 39

